

Fox Wood Garden Village

Whiston, Merseyside L35 3SS

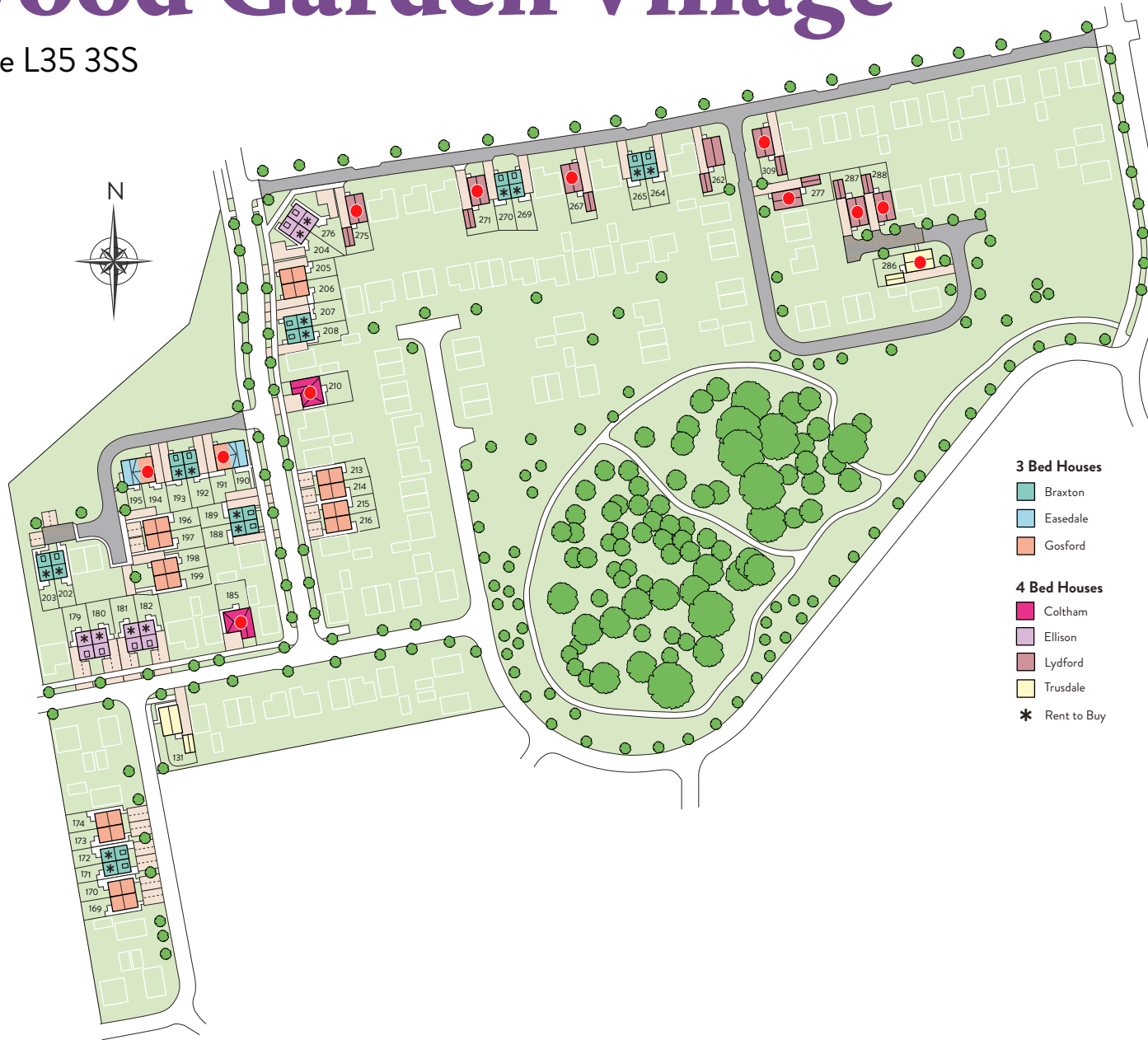

Foxwood Garden Village Price List

Shared Ownership

Available homes

Plot(s)	Description	House Type	Price	25% Share & Monthly Rent	50% Share & Monthly Rent	75% Share & Monthly Rent
197 198 199 205 206 213 214 215 216	3 bedroom semi detached	Gosford	£265,000	£66,250 & £455.47	£132,500 & £303.65	£198,750 & £151.82
190 195	3 bedroom semi detached CT (corner turn)	Easdale	£280,000	£70,000 & £481.25	£140,000 & £320.83	£210,000 & £160.42
262	4 bedroom detached & garage	Lydford	£340,000	£85,000 & £584.38	£170,000 & £389.58	£255,000 & £194.79

Availability is subject to change and can do so with no prior notice.

Disclaimer: Values are reviewed every 3 months and are subject to change. A monthly service charge will apply to Shared Ownership homes. Prices, features and availability are correct at time of print but are subject to change without prior notice.

Please note, we do not have a site presence. Viewings will be arranged following a successful application and sign-off from our dedicated mortgage broker.

The Gosford

866 sqft



Ground Floor

Lounge	3.69m x 4.26m	12'1" x 14'0"
Kitchen/Dining	4.72m x 2.87m	15'6" x 9'5"

First Floor

Master Bedroom	3.69m x 2.83m	12'1" x 9'4"
Bedroom 2	2.63m x 3.30m	8'8" x 10'10"
Bedroom 3	2.00m x 3.55m	6'7" x 11'8"

The Easedale

931 sqft



Ground Floor

Lounge	3.02m x 5.10m	9'11" x 16'9"
Kitchen/Dining	2.95m x 5.10m	9'8" x 16'9"



First Floor

Master Bedroom	3.08m x 3.81m	10'1" x 12'6"
Bedroom 2	2.95m x 2.86m	9'8" x 9'5"
Bedroom 3	2.95m x 2.15m	9'8" x 7'1"

The Braxton

1092 sqft



Ground Floor

Lounge	3.19m x 4.19m	10'6" x 13'9"
Kitchen/Dining	4.25m x 3.43m	14'0" x 11'3"

First Floor

Bedroom 2	4.25m x 2.82m	14'0" x 9'3"
Bedroom 3	2.15m x 3.59m	7'1" x 11'10"

Second Floor

Master Bedroom	6.64m x 4.25m	21'10" x 9'1"
----------------	---------------	---------------

The Lydford

1099 sqft



Ground Floor

Lounge	3.27m x 4.43m	10'9" x 14'6"
Kitchen/Dining	5.36m x 3.38m	17'7" x 11'1"

First Floor

Master Bedroom	3.17m x 3.79m	10'5" x 12'5"
Bedroom 2	3.17m x 3.35m	10'5" x 11'0"
Bedroom 3	2.10m x 3.30m	6'11" x 10'10"
Bedroom 4	2.23m x 2.10m	7'4" x 6'11"

The Trusdale

1226 sqft



Ground Floor

Lounge	3.46m x 6.09m	11'4" x 20'0"
Kitchen/Dining	3.58m x 6.09m	11'9" x 20'0"



First Floor

Master Bedroom	3.52m x 3.74m	11'7" x 12'4"
Bedroom 2	3.64m x 2.95m	11'11" x 9'8"
Bedroom 3	2.51m x 3.05m	8'3" x 10'0"
Bedroom 4	3.54m x 2.25m	11'7" x 7'5"

The Elliston

1249 sqft



Ground Floor

Lounge	3.81m x 4.26m	12'6" x 14'0"
Kitchen/Dining	4.89m x 2.90m	16'1" x 9'6"

First Floor

Bedroom 2	2.73m x 3.15m	7'8" x 10'10"
Bedroom 3	2.34m x 3.31m	7'8" x 10'10"
Bedroom 4	2.45m x 3.31m	8'1" x 10'10"

Second Floor

Master Bedroom	3.89m x 6.64m	12'9" x 21'10"
----------------	---------------	----------------

The Coltham

1241 sqft



Ground Floor

Lounge	3.84m x 4.53m	12'7" x 14'11"
Kitchen/Dining	5.39m x 2.86m	17'8" x 9'5"



First Floor

Master Bedroom	3.84m x 3.10m	12'7" x 10'2"
Bedroom 2	3.66m x 3.15m	12'0" x 10'4"
Bedroom 3	3.33m x 3.40m	10'11" x 11'2"
Bedroom 4	2.58m x 2.88m	8'6" x 9'6"