



KINGS PARK MACCLESFIELD



Kings Park, Fence Avenue, Macclesfield, Cheshire, SK10 1LT

Description	House Type	Price	25% Share & Monthly Rent	50% Share & Monthly Rent	75% Share & Monthly Rent
2 bed room end mews home	Brookvale	£292,500	£73,12 & £502.73	£146,25 & £335.16	£219,37 & £167.58

Disclaimer: Values are reviewed every 3 months and are subject to change. A monthly service charge will apply. Prices, features and availability are correct at time of print but are subject to change without prior notice.

BROOKVALE

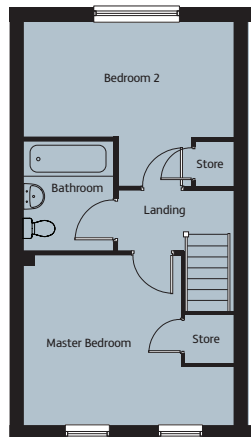
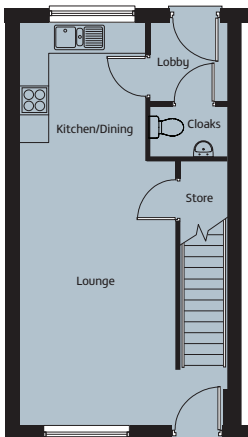

Ground Floor

Lounge	3195mm x 5100mm
WC	1522mm x 1050mm
Kitchen/Dining	2590mm x 3050mm
Lobby	1522mm x 1680mm

First Floor

Bedroom 1	4200mm x 3450mm
Bedroom 2	4200mm x 2306mm
Bathroom	1825mm x 2207mm
Stairs 2nd Floor	1000mm x 6000mm
Landing	2299mm x 1246mm